



SecureTouch 1ml Luer-Lock Syringe with Hypodermic Safety Needle



Features

- Sterile, Non-Toxic, Non-Pyrogenic
- One-Handed Activation
- No Solid Surface Required
- Simple Finger Stroke Activation
- Protective arm keeps fingers behind the needle
- An audible “click” as well as tactile feel and a visual indicator confirm safety mechanism engagement
- Needle remains locked inside activated cover
- Safety shield can be pushed back comparative to the needle allowing a clear view of the injection site.
- This product does not contain Natural Rubber Latex

Specifications

Pieces: 300

Weight: 5.34 lbs (2.42 kgs)

Dimensions: Length: 16 in x Width: 10 in x Height: 8 in (406 mm x 254 mm x 203 mm)

Packages: Available 50 per box or 300 per case

Specifications vary slightly between sizes. Packaging subject to change.

Product No	Description	Hub Color
27044	25G x 5/8"	Orange ■

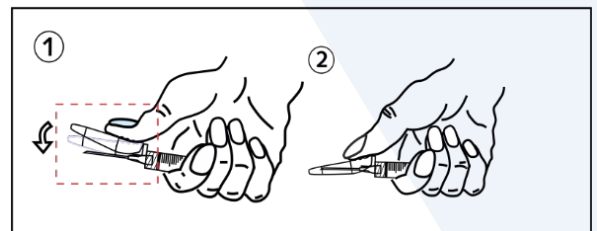
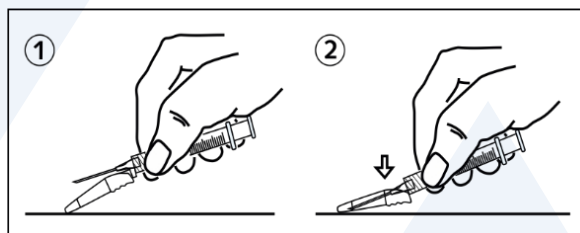

SecureTouch[®]

Headquarters
+1-310-649-0707
www.exelmed.com

The EXEL logo is a registered trademark of EXEL International Company.